

---

# TRANSITION TO THE DOWNTOWN CAMPUS

---

Business and Financial Strategic Initiatives

---

# DOWNTOWN AND THE CAMPUS VISION

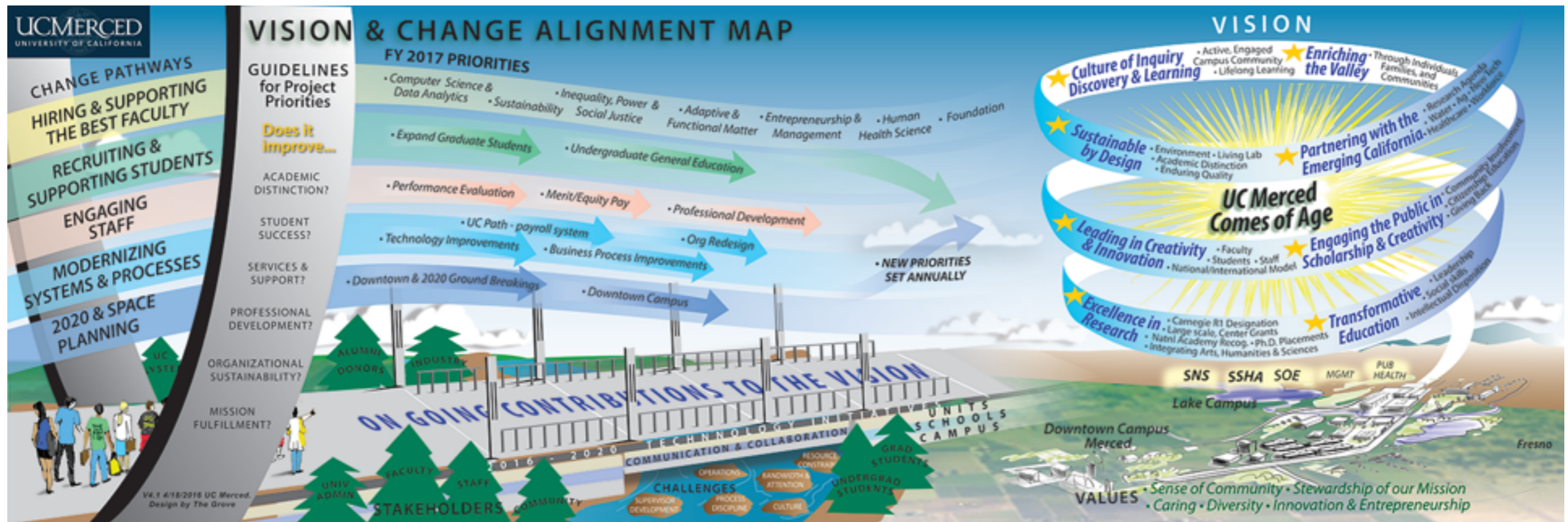

- Partnering with the Emerging California
- Organizational Sustainability
- Enriching the Valley
- Fiscal Sustainability

---

# TRANSITION TEAM

---

- Michael Reese, VC BAS - Executive Sponsor
  - Andy Boyd, BFSI, - Transition Team Executive Advisor
  - Jason Martin, BFSI - Transition Team Lead
  - Cruz Franco, BFSI - Project Coordinator
  - Jessica Duffy, BFSI - Project Management Support
  - Michael Chow, D&C - Design and Construction Lead
  - Leon Waller, D&C - Design and Construction Lead
-

---

# CURRENT CONSTRAINTS AND OPPORTUNITIES

---

---

# TRANSITION PLANNING

---



- Neighborhoods
  - Project Workstreams
  - Staff Engagement
-

---

# NEIGHBORHOODS

---

- **Neighborhood is defined as:** Two or more departments co-located in the same area of the building.
  - **Criteria for neighborhood placement was based on your feedback:** Working style, operational needs and opportunities to be next to those you work the closest with (functional adjacency)
-

# Floor 1

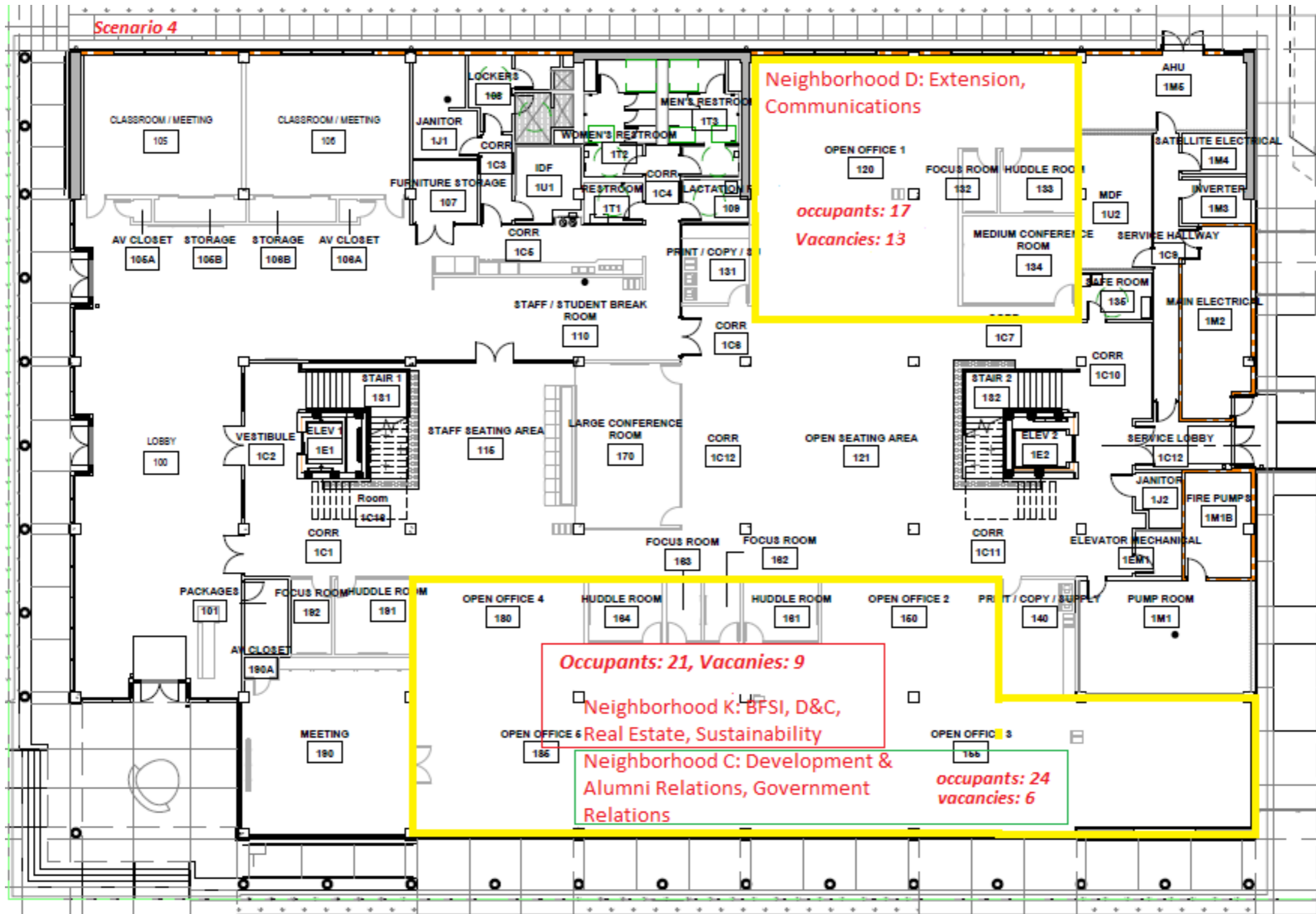

## Floor 2

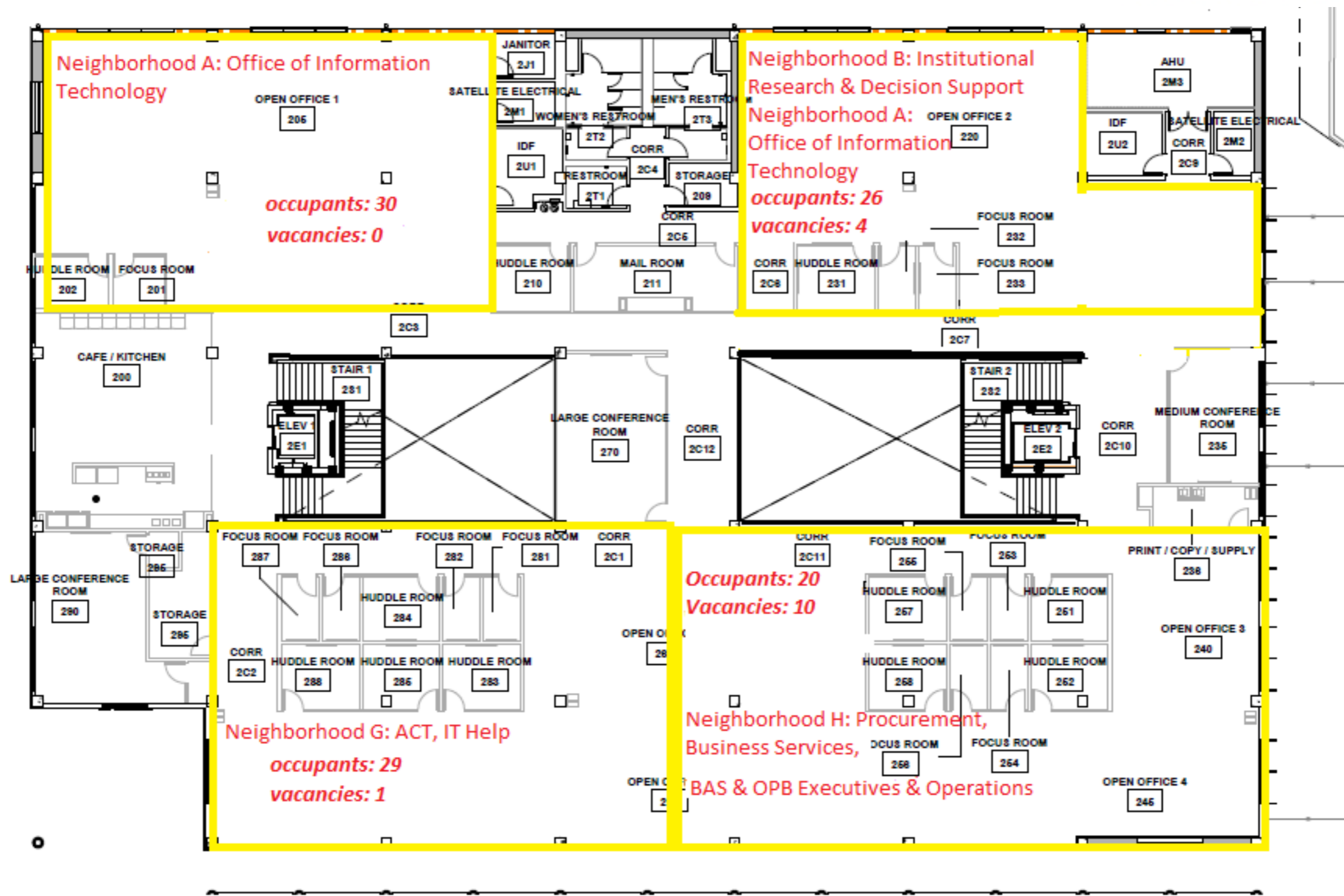



# Floor 3

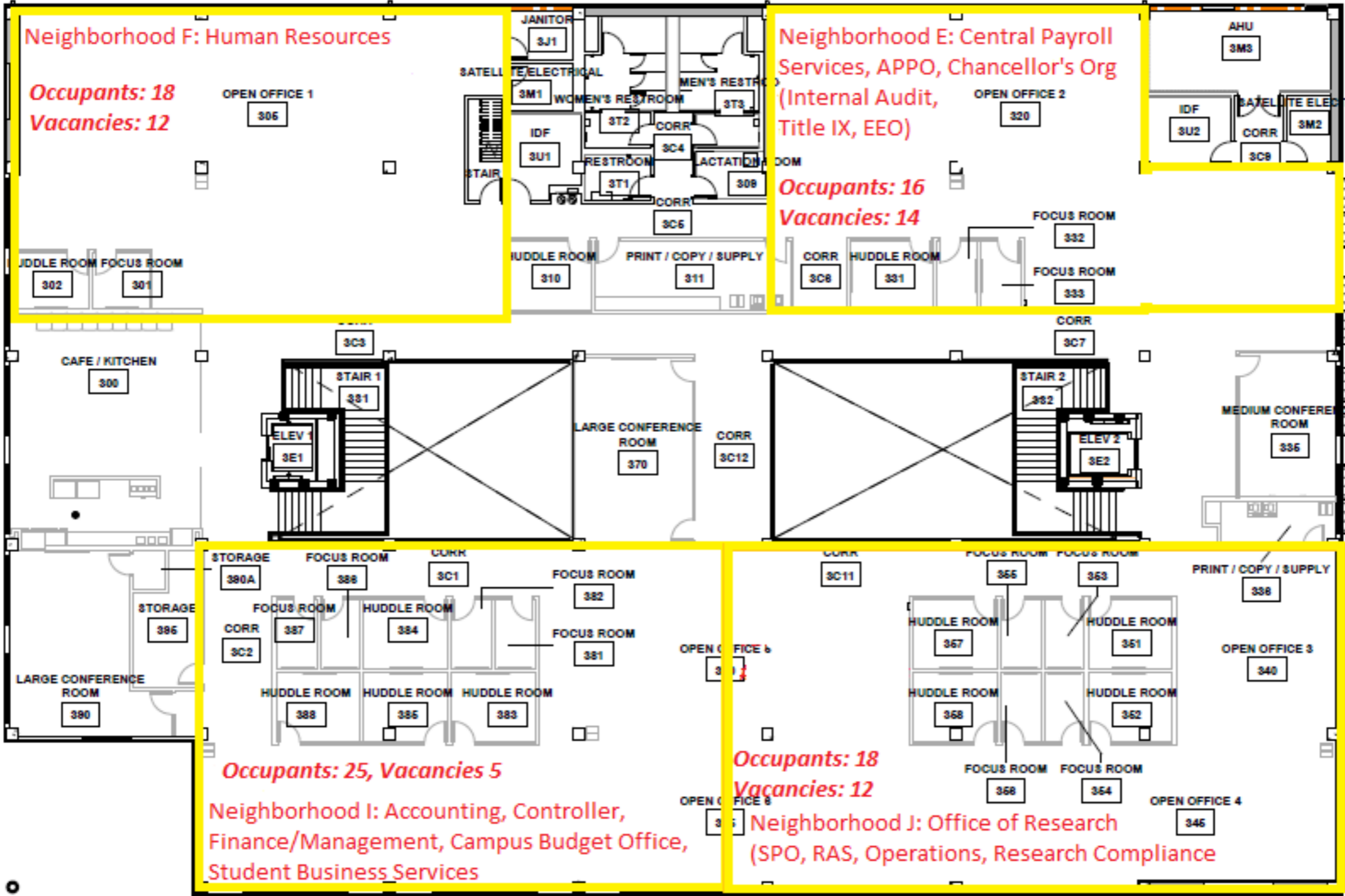

---

# PROJECT WORKSTREAMS

---

- **Business Process Transformation: Going paperless**
  - **Technology**
  - **Space Planning and Culture**
  - **Governance**
  - **Ergonomics**
  - **Communication**
  - **One-Team**
  - **Training**
  - **Alternative Work and Campus Workspace**
  - **Safety, Parking and Transportation**
-

# Downtown Campus Center Engagement Roadmap

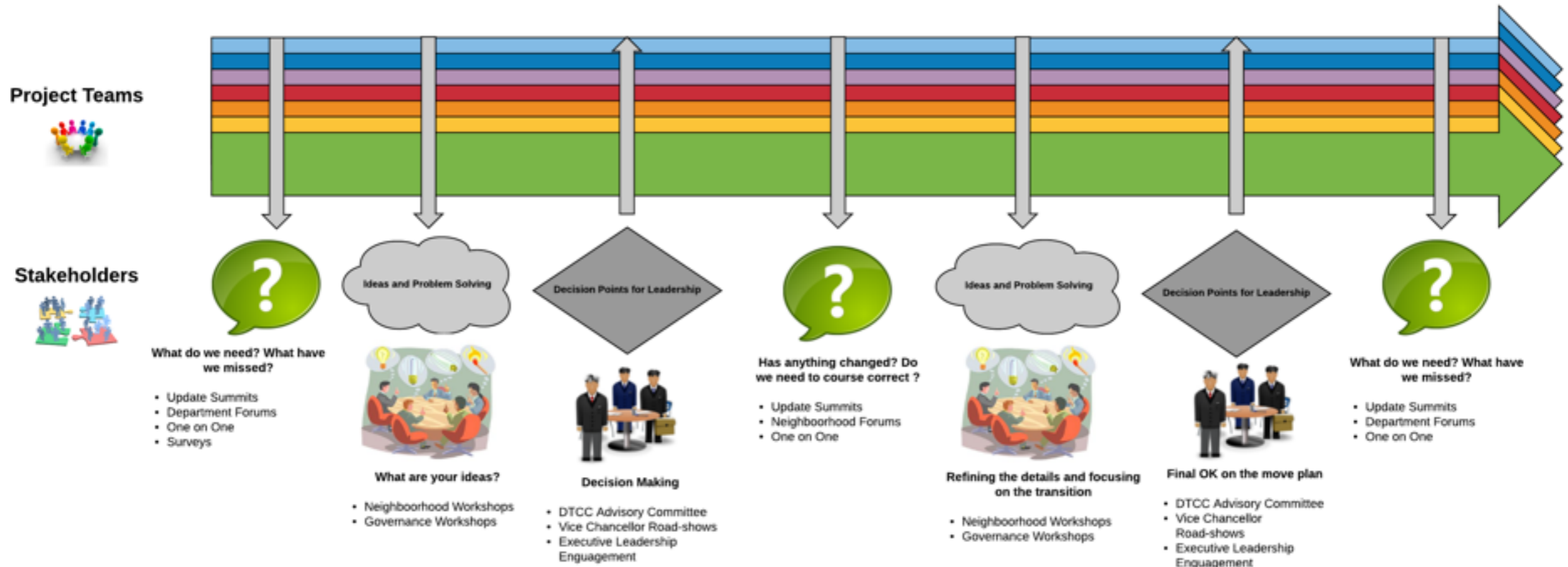

---

# WHAT IS NEXT?

---



- **Neighborhood workshops with Leaders, managers and staff to get input on furniture type, layout and other space planning needs.**